

ENCINO COURTYARD

17401 VENTURA BLVD // ENCINO, CA, 91316

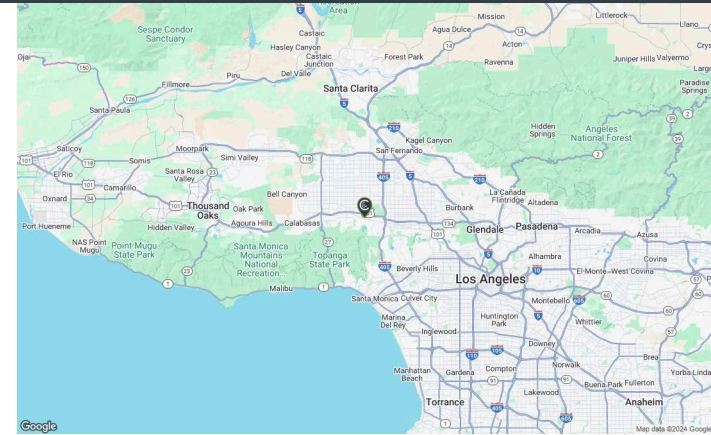

OWNED GLA
99,677 SF

LOCATION
Longitude: -118.512314
Latitude: 34.161858

DEMOGRAPHICS	1 Mile	3 Mile	5 Mile
Population	24,664	136,941	439,489
Avg Income	\$128,199	\$124,404	\$106,643

- Infill center anchored by Bed Bath & Beyond and LA Fitness; population over 440k in a 5 mile radius
- Strong frontage on Ventura Blvd (~50k vehicles per day)



FOR LEASING INFORMATION
Mark Ross
858-798-1465
mross@shopcore.com
www.ShopCore.com

ENCINO COURTYARD

17401 VENTURA BLVD // ENCINO, CA, 91316

FIRST FLOOR

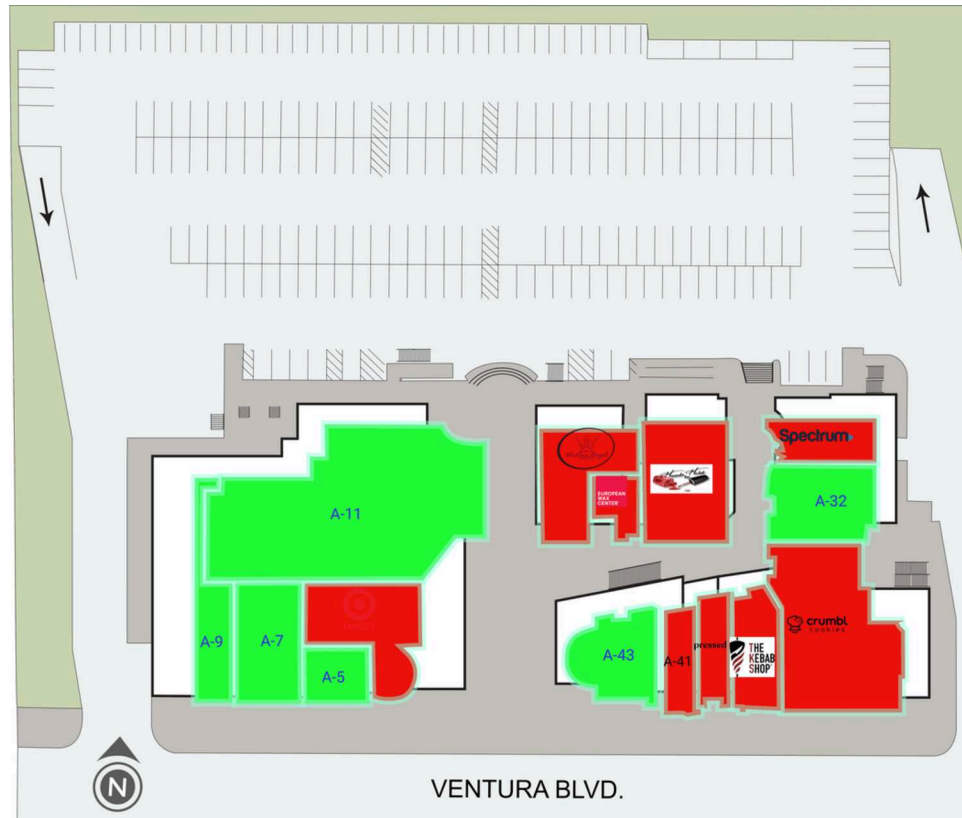

SUITE#	Tenant Name	GLA(SF)	SUITE#	Tenant Name	GLA(SF)	SUITE#	Tenant Name	GLA(SF)	SUITE#	Tenant Name	GLA(SF)
A-1	TARGET	17,659 SF	A-32	AVAILABLE	2,022 SF	A-43	AVAILABLE	2,347 SF	REST1	SHAKE SHACK INC.	2,963 SF
A-11	AVAILABLE	30,000 SF	A-35	CRUMBL COOKIES	2,069 SF	A-5	AVAILABLE	885 SF	REST3	WESTERN BAGEL	2,337 SF
A-17	WESTERN BAGEL	2,337 SF	A-36	BLAZE PIZZA	2,094 SF	A-7	AVAILABLE	2,176 SF	REST4	BLAZE PIZZA	2,094 SF
A-25	HANDS TO HOLD	1,600 SF	A-37	THE KEBAB SHOP	2,077 SF	A-9	AVAILABLE	2,167 SF	RTAIL4	SPECTRUM	3,565 SF
A-27	EUROPEAN WAX CENTER	1,344 SF	A-39	PRESSED JUICERY	951 SF	B-1	PLANET FITNESS	20,911 SF	TARGET	TARGET (NAP)	49,420 SF
A-29	SPECTRUM	3,565 SF	A-41	SHAKE SHACK INC.	2,963 SF	B-12	OAKBERRY ACAI BOWLS & S...	1,013 SF	UNIT 2	HANDS TO HOLD	1,600 SF

This document is for general information purposes only. Any and all features, matters and other information depicted hereon or contained herein are for illustrative marketing purposes only, are subject to modification without notice, are not intended to be relied upon by any party and are not intended to constitute representations or warranties as to any matter, including ownership of the real property depicted hereon, the size and nature of improvements (or that any improvements will be constructed or will continue to exist as depicted), or the identity or nature of any occupants thereof.



FOR LEASING INFORMATION
Mark Ross
858-798-1465
mross@shopcore.com
www.ShopCore.com

ENCINO COURTYARD

17401 VENTURA BLVD // ENCINO, CA, 91316

SECOND FLOOR

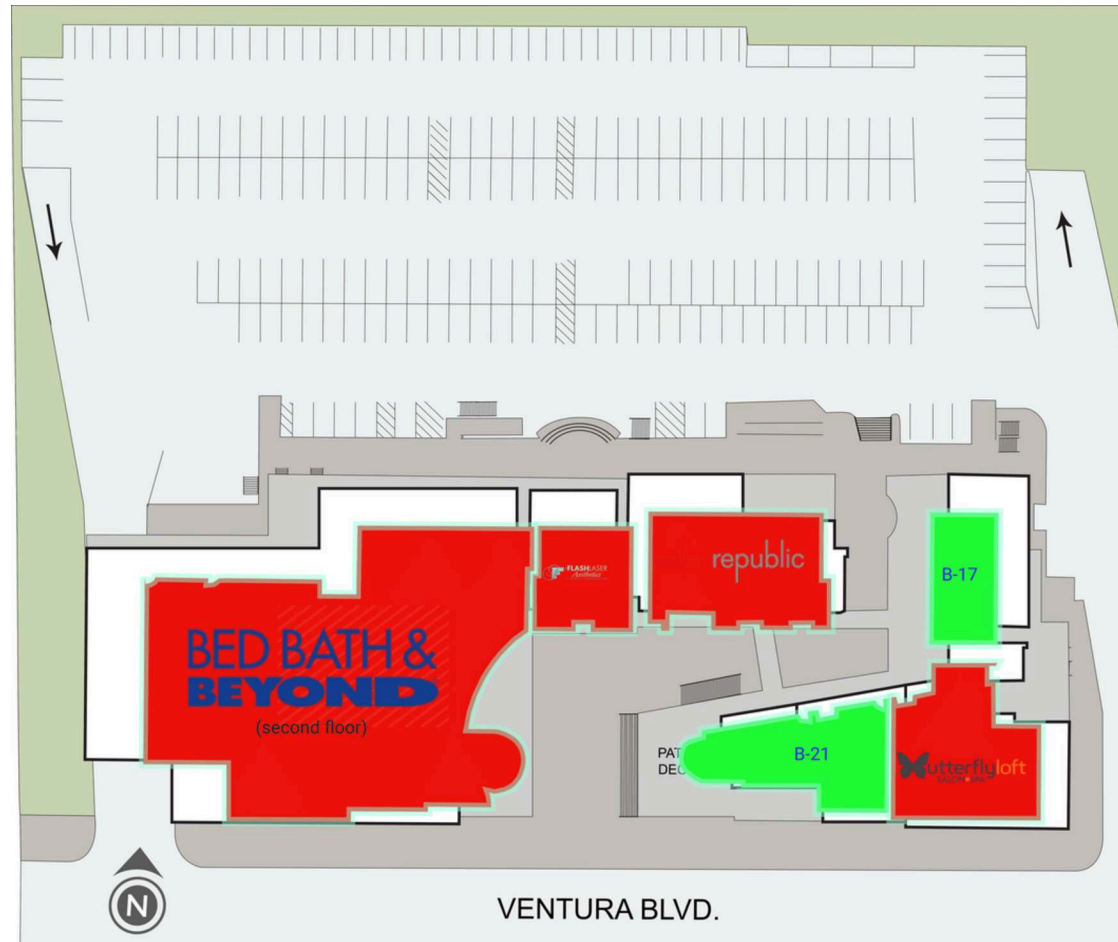

SUITE#	Tenant Name	GLA(SF)	SUITE#	Tenant Name	GLA(SF)	SUITE#	Tenant Name	GLA(SF)	SUITE#	Tenant Name	GLA(SF)
B-1	PLANET FITNESS	20,911 SF	B-13	SALON REPUBLIC	6,246 SF	B-19	BUTTERFLY LOFT SALON & ...	4,061 SF	B-21	AVAILABLE	4,307 SF
B-12	OAKBERRY ACAI BOWLS & ...	1,013 SF	B-17	AVAILABLE	2,071 SF	B-20	PETROCK HOTEL AND SPA	2,406 SF	B-9	FLASHLASE AESTHETICS	1,886 SF

This document is for general information purposes only. Any and all features, matters and other information depicted hereon or contained herein are for illustrative marketing purposes only, are subject to modification without notice, are not intended to be relied upon by any party and are not intended to constitute representations or warranties as to any matter, including ownership of the real property depicted hereon, the size and nature of improvements (or that any improvements will be constructed or will continue to exist as depicted), or the identity or nature of any occupants thereof.



FOR LEASING INFORMATION
 Mark Ross
 858-798-1465
 mross@shopcore.com
 www.ShopCore.com

ENCINO COURTYARD

17401 VENTURA BLVD // ENCINO, CA, 91316

SUB-LEVEL

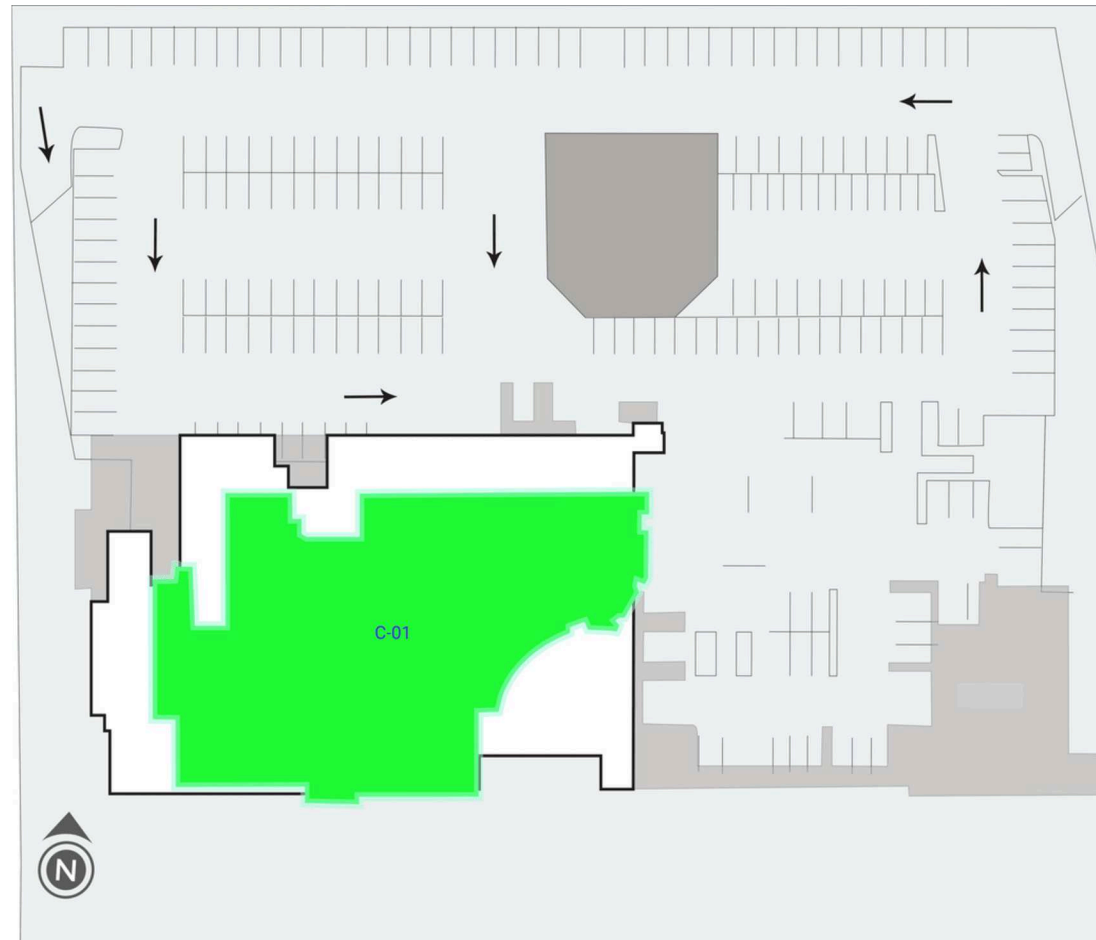

SUITE#Tenant Name		GLA(SF)	SUITE#Tenant Name		GLA(SF)	SUITE#Tenant Name		GLA(SF)
B-1	PLANET FITNESS	20,911 SF	B-12	OAKBERRY ACAI BOWLS & ...	1,013 SF	C-01	AVAILABLE	24,747 SF

This document is for general information purposes only. Any and all features, matters and other information depicted hereon or contained herein are for illustrative marketing purposes only, are subject to modification without notice, are not intended to be relied upon by any party and are not intended to constitute representations or warranties as to any matter, including ownership of the real property depicted hereon, the size and nature of improvements (or that any improvements will be constructed or will continue to exist as depicted), or the identity or nature of any occupants thereof.



FOR LEASING INFORMATION
Mark Ross
858-798-1465
mross@shopcore.com
www.ShopCore.com